

Dry Disconnect Couplings

Dry Disconnect Quick-release Self-sealing Couplings

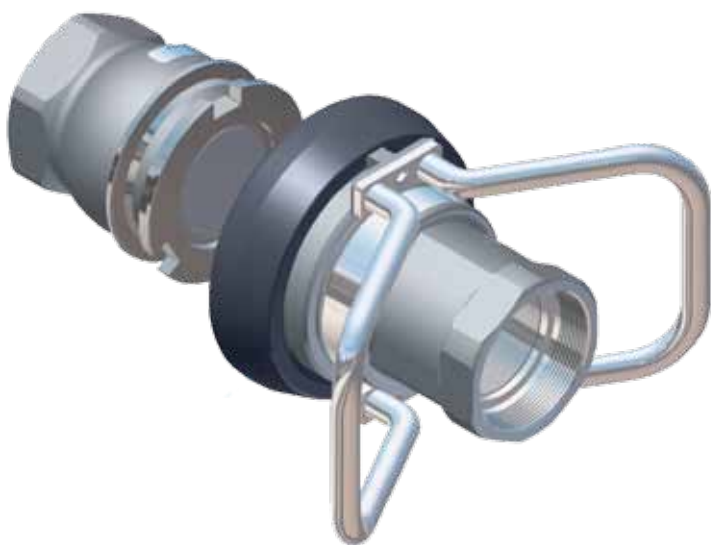

Size	The couplings are available in sizes from ¾" (DN 20) to 6" (DN 150) with BSP-, NPT- and S60X6-threads. Other threads available upon request. The tank units are also available in flanged connections (DIN, ANSI, TW, TTMA, EN 1092-1:2001).
Materials	Aluminium, Brass/Gunmetal, Stainless Steel, Hastelloy C and PEEK. Other materials upon request. All inner parts in Stainless Steel, SS 316.
Seals	FPM (Viton®), EPDM, Chemraz®, Kalrez®, NBR (Nitrile). Other materials upon request.
Working pressure	PN 10 - PN 25.
Selectivity - Avoid mixing products	To avoid product contamination caused by connecting a hose unit to the wrong tank unit, selective versions of the hose and tank units are available. Each unit has a number of selective positions, designated by a coded part number according to the coupling size - specify when placing order.
Electrical conductivity	All DDCouplings® have electrical conductivity (<10 ohms).
Interchangeability	Compatibility with other existing brands according to NATO STANAG 3756 and ATOFINA SGM 2049.TUY.C.
Special models	With integrated break-away, pressure relief valve, etc. upon request.

Tools



Tools for draining of tank units



Tools for draining of hose units



Open end wrench for tank and hose unit

Option – Coloured couplings and handles



Industrial Breaking Bolt Series

Industrial Break-away coupling



Industrial break-away couplings are utilised in all industrial product transfer installations. The industrial SBCouplings are specifically designed to be able to activate with a tensile force being applied at an angle to the plane of the coupling housing, up to 90 degrees.

Advantages

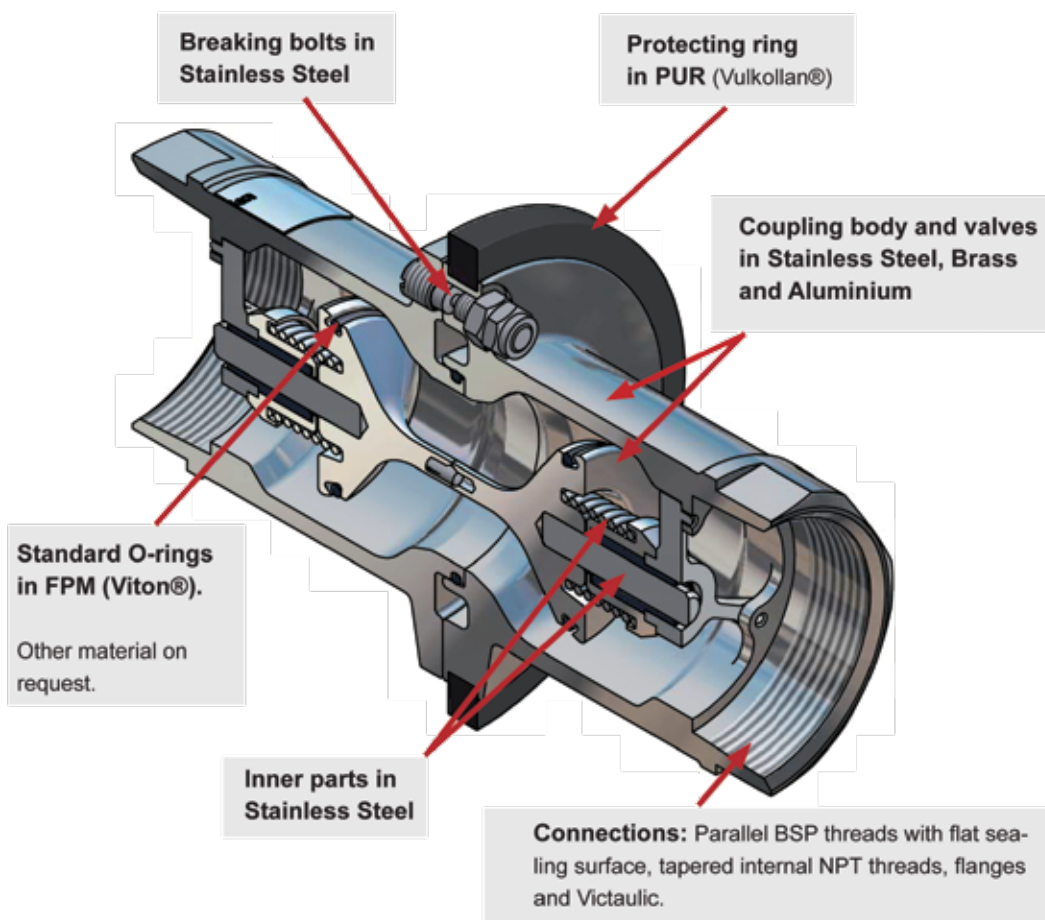

Bayco Dry Disconnects (interchangeable with OPW's Kamvalok™)

Couplers

- dry disconnect coupler has automatic closing poppet assembly
- heavy duty stainless steel crank and link provide long service life
- stainless steel handle allows product exposure to corrosive chemicals or washdown service
- strong handle attachment prevents bending of crank assembly
- fully interchangeable with Kamvalok™ (OPW trademark) style fittings
- aluminum fittings have stainless steel internals
- for pressure ratings at other temperatures, contact the factory
- Dixon EZ Boss-Lock cam arms provide high security from accidental opening due to vibration or snagging on 1½" and 2" fittings
- large EZ Boss-Lock paddle type cam arms allow for an easy grip on 3" fittings

Must be used with a DBA style adaptor for coupler to operate. Adaptor sold separately.



1½" and 2" coupler x female NPT/BSP



3" coupler x female NPT/BSP

Coupler x female NPT/BSP

Female NPT/BSP	Coupler Size	Seal Material	Max. PSI at 70°	Aluminum Part #	OPW Part #	Stainless ¹ Part #	OPW Part #
1½"	2"	Buna	210	DBC61-150	1711D-	DBC71-150	1771D-SS15
2"	2½"		150	DBC61-200	AL15/1761	DBC71-200	1771D-SS20
3"	4"		120	DBC61-300	1711D-AL20/1761 1711D-AL30	DBC71-300	1771D-SS30
1½"	2"	Viton®	210	DBC62-150	1712D-	DBC72-150	1772D-SS15
2"	2½"		150	DBC62-200	AL15/1762	DBC72-200	1772D-SS20
3"	4"		120	DBC62-300	1712D-AL20/1762 1712D-AL30	DBC72-300	1772D-SS30
1½"	2"	Teflon® Encapsulated Silicone & Kalrez®	210	DBC63-150	1763D-AL15	DBC73-150	1773D-SS15
2"	2½"		150	DBC63-200	1763D-AL20	DBC73-200	1773D-SS20
3"	4"		120	DBC63-300	1763D-AL30	DBC73-300	1773D-SS30
1½"	2"	EPT (EPDM)	210	DBC64-150	1764D-AL15	DBC74-150	1774D-SS15
2"	2½"		150	DBC64-200	1764D-AL20	DBC74-200	1774D-SS20
3"	4"		120	DBC64-300	1764D-AL30	DBC74-300	1774D-SS30
1½"	2"	Kalrez® and Teflon® ²	210	DBC66-150	1766D-AL15	DBC76-150	1776D-SS15
2"	2½"		150	DBC66-200	1766D-AL20	DBC76-200	1776D-SS20
3"	4"		120	DBC66-300	1766D-AL30	DBC76-300	1776D-SS30
1½"	2"	Teflon® Encapsulated Viton® & Kalrez®	210	DBC67-150	1777D-AL15	DBC77-150	1777D-SS15
2"	2½"		150	DBC67-200	1777D-AL20	DBC77-200	1777D-SS20
3"	4"		120	DBC67-300	1777D-AL30	DBC77-300	1777D-SS30
3"	4"	Viton® B	120	DBC69-300	1779D-AL30	DBC79-300	1779D-SS30

Greaseless coupler x female NPT/BSP

Female NPT/BSP	Coupler Size	Seal Material	Max. PSI at 70°	Stainless ¹ Part #	OPW Part #
1½"	2"	Teflon®	210	DBC77-150-GL	1777D-SS15-GL
2"	2½"	Encapsulated Viton® & Kalrez®	150	DBC77-200-GL	1777D-SS20-GL

Coupler x 90° swivel female NPT/BSP

Female NPT/BSP	Coupler Size	Seal Material	Max. PSI at 70°	Aluminum Part #	OPW Part #
2"	2½"	Buna	150	DBS61-200	1711ES-0200
2"	2½"	Viton®	150	DBS62-200	1712ES-0200
2"	2½"	Teflon® Encap. Silicone and Kalrez®	150	DBS63-200	



1 stainless steel corrosion resistance is comparable to 304 stainless steel

2 Kalrez® gasket, main seal O-ring and handle O-ring. Teflon® seals on cylinder assembly, stuffing box & seal under poppet screw.

Locking Handle Kit for Couplers

Part #	Description
DBCL-200	locking handle kit for 1½" and 2" dry disconnects
DBCL-300	locking handle kit for 3" dry disconnects



Adaptors

Compatible with most cam and groove style dry disconnects. The Bayco dry disconnect helps prevent spillage from normal or accidental disconnects. A spring loaded sealing device is designed to "snap" closed should the valve become disconnected with the poppet open, significantly limiting liquid loss.

Our dry disconnect couplings are available in a wide range of sizes, metals, and seal materials. Special configurations can be designed for your application.

- two-piece adaptor design for easy rebuilding of adaptors
- fully interchangeable with Kamvalok™ (OPW trademark) style fittings
- aluminum fittings have aluminum nose piece and brass piston
- for pressure ratings at other temperatures, contact the factory

Must be used with a DBC style coupler for adaptor to operate. Couplers sold separately.

Female NPT/BSP	Coupler Size	Seal Material	Max. PSI at 70°	Aluminum Part #	OPW Part #	Stainless ¹ Part #	OPW Part #
1½"	2"	Buna	210	DBA11-150	1611AN-AL15	DBA71-150	1671AN-SS15
2"	2½"		150	DBA11-200	1611AN-AL20	DBA71-200	1671AN-SS20
3"	4"		120	DBA11-300	1611AN-AL30	DBA71-300	1672AN-SS30
1½"	2"	Viton®	210	DBA12-150	1612AN-AL15	DBA72-150	1672AN-SS15
2"	2½"		150	DBA12-200	1612AN-AL20	DBA72-200	1672AN-SS20
3"	4"		120	DBA12-300	1612AN-AL30	DBA72-300	1672AN-SS30
1½"	2"	Buna		DBA61-200	1611AN-AL20	–	–
2"	2½"	Viton®		DBA62-200	1612AN-AL20		
1½"	2"	Teflon®	210	DBA63-150	1613AN-AL15	DBA73-150	1673AN-SS15
2"	2½"	Encapsulated	150	DBA63-200	1613AN-AL20	DBA73-200	1673AN-SS20
3"	4"	Silicone	120	DBA63-300	1613AN-AL30	DBA73-300	1673AN-SS30

Female NPT/BSP	Coupler Size	Seal Material	Max. PSI at 70°	Aluminum Part #	OPW Part #	Stainless ¹ Part #	OPW Part #
1½"	2"	EPT (EPDM)	210	DBA64-150	1614AN-AL15	DBA74-150	1674AN-SS15
2"	2½"		150	DBA64-200	1614AN-AL20	DBA74-200	1674AN-SS20
3"	4"		120	DBA64-300	1614AN-AL30	DBA74-300	1674AN-SS30
1½"	2"	Kalrez®	210	DBA66-150	1616AN-AL15	DBA76-150	1676AN-SS15
2"	2½"		150	DBA66-200	1616AN-AL20	DBA76-200	1676AN-SS20
3"	4"		120	DBA66-300	1616AN-AL30	DBA76-300	1676AN-SS30
1½"	2"	Teflon® Encapsulated Viton®	210	DBA67-150	1617AN-AL15	DBA77-150	1677AN-SS15
2"	2½"		150	DBA67-200	1617AN-AL20	DBA77-200	1677AN-SS20
3"	4"		120	DBA67-300	1617AN-AL30	DBA77-300	1677AN-SS30
3"	4"	Viton® B	120	DBA69-300	1619AN-AL30	DBA79-300	1679AN-SS30

Jump size adaptor x female NPT/BSP

Female NPT/BSP	Coupler Size	Seal Material	Max. PSI at 70°	Aluminum Part #	OPW Part #
2"	2"	Buna	150	DBA11-1520	–
2"	2"	Viton®	150	DBA12-1520	



Vapour adaptor x female thread

Female NPT/BSP	Coupler Size	Seal Material	Max. PSI at 70°	Stainless ¹ Part #	OPW Part #
3"	2½"	Teflon®	150	DBVA73-2030	2173AVN

¹ stainless steel corrosion resistance is comparable to 304 stainless steel.
Note: Please reference pages 89 and 90 for repair kits and replacement parts.

Dry Link Couplings



Drip-free design

- Minimises exposure to fluids in the line
- Eliminates costly clean-ups
- Offers greater protection for workers and the environment

Better flow

- Fewer internal components create a better flow rate
- Smooth bore, simple configuration of dry link assembly results in lowest pressure drop available
- Ideal for higher viscosity fluids

Avoids spills

- Identical disc halves securely shut off flow in the line
- Mechanical interlock prevents accidental openings
- Discs are closed and sealed before coupler and adaptor can be separated

Easier operation

- Up to 50% lighter than comparable dry disconnect units
- Coupler has built-in swivel that eases alignment
- Parts are accessible for ease of maintenance